 ÁREA DE LOTES (1.020m²)
 CEDÊNCIA OBRIGATÓRIA (692)

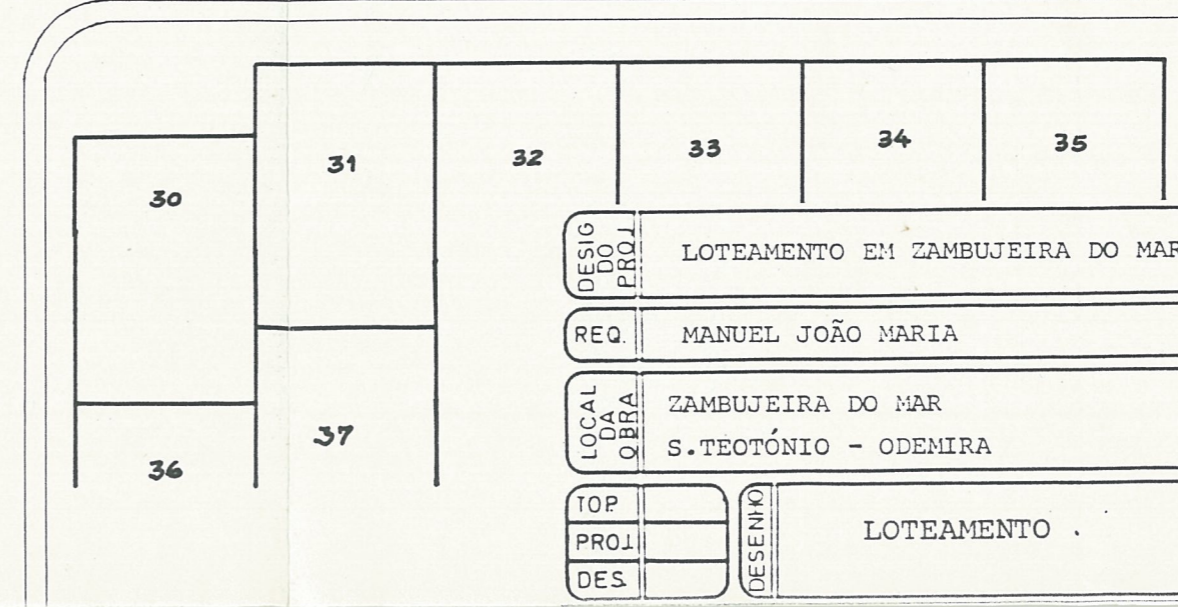
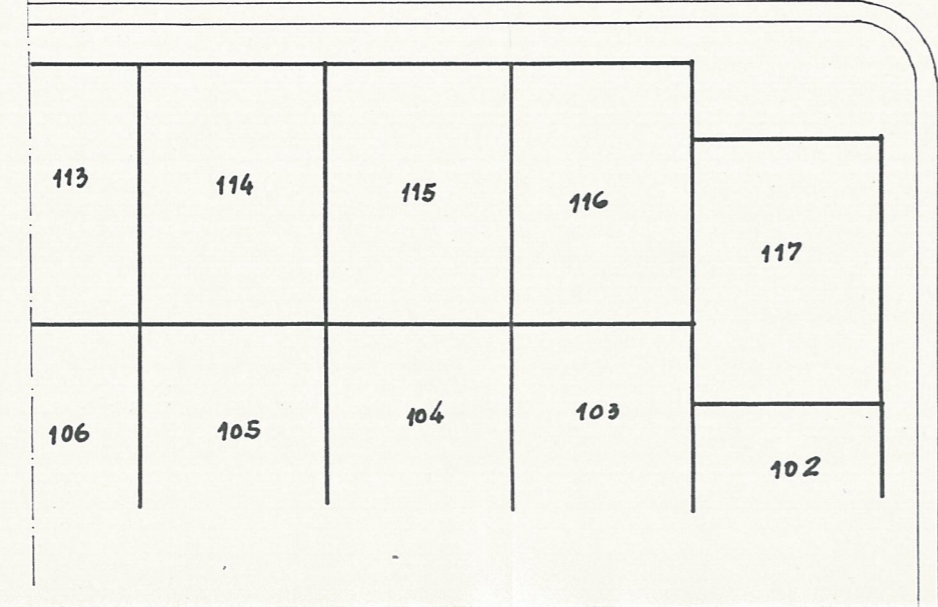
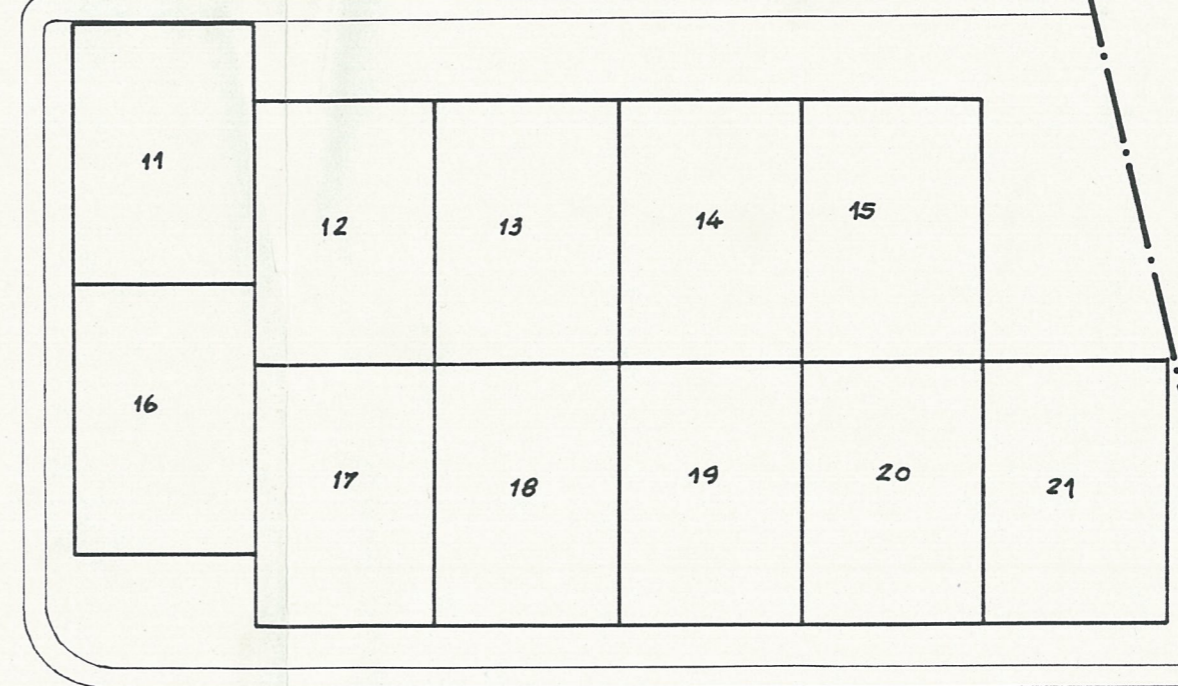
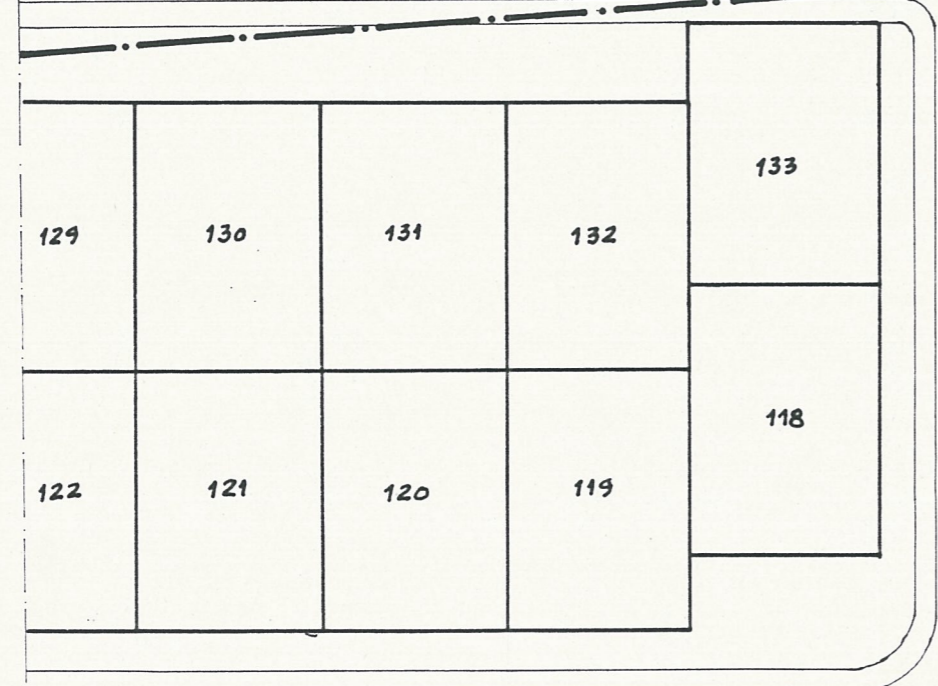

APROVADO

REUNIÃO DE 2/5/19

DESIG DO PROJ	LOTEAMENTO EM ZAMBUJEIRA DO MAR			Nº GER	
REQ.	MANUEL JOÃO MARIA				
LOCAL DA OBRA	ZAMBUJEIRA DO MAR S. TEOTÓNIO - ODEMIRA			TÉCNIC	
TOP		DESENHO	LOTEAMENTO	SUBSTITUI O	
PROJ				SUBSTITUIDO P	
DES					
				ESCALA	1/50
				NÚMERO	3